

The scope in the swell waves

- Error handling strategy -

Sachi Miyachi

Open studio:

10 – 30 December 2012

14:00–15:00 Performing festivals

Exhibition:

13 January – 17 February 2013

Opening:

13 January 2013

18:00 – Dinner

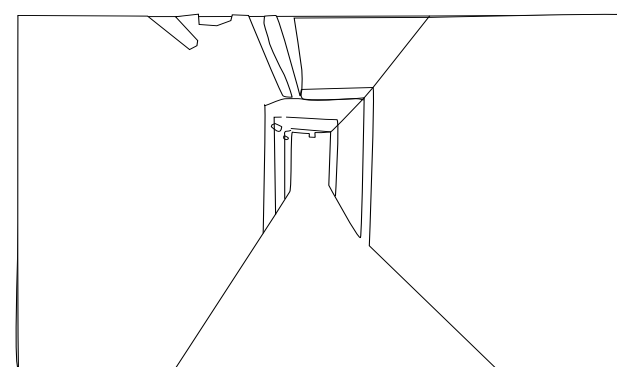
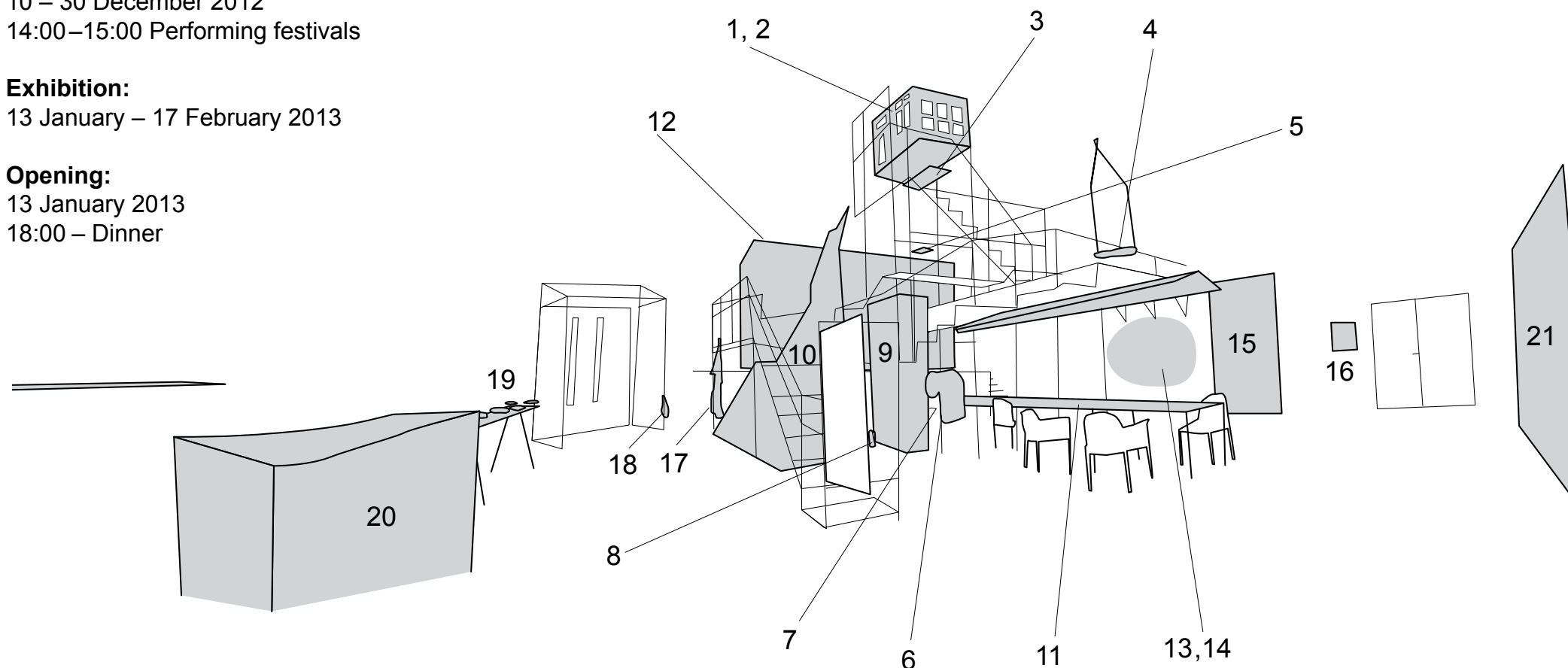

22

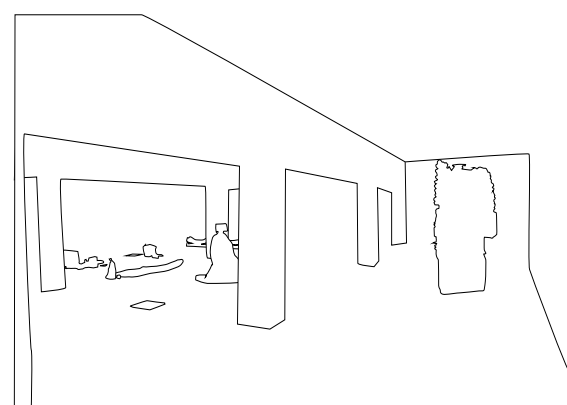

23

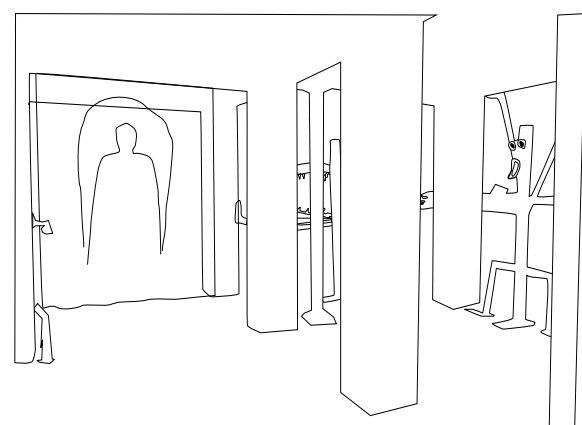

24

1. *A sleeping cabin*
2. *Tools for resisting the magnetic field, extra tool: customised buckwheat pillow for sleeping cabin*
Nina Glockner
3. *LA CASSETTA Di DOKiNSHAN*
Dafna Nur
4. *A platform for a swing*
5. *Repairing earthquake project 2012, object #82*
Nishiko
6. *Tools for resisting the magnetic field, tool II : buckwheatpeelspillowroll*
Nina Glockner
7. *Mobility and flexibility*
Nishiko
8. *A fire extinguisher*
Sachi Miyachi
9. *Tofu box*
10. *A slice of mountain*
Esther de Graaf
11. *A long dinner table*
12. *A place for 'Spring festivals'*
13. *An attempt to map Sachi Miyachi's Brain*
Annemiek-Stéphane Cornelissen-Douady
14. *Mapping a Construction of Sachi Miyachi's*
Annemiek-Stéphane Cornelissen-Douady
15. *Through the veins of our thoughts*
Ank Daamen
16. *A painting of oranges*
Unknown
17. *Sharing a day and a half with breathing*
Eiko Ishizawa
18. *Stairs*
Sachi Miyachi
19. *Tools for resisting the magnetic field, tool I : cheeryseedshandsheltermachine*
Nina Glockner
20. *Kitchen*
21. *Milk made*
Ank Daamen
22. *Cherry stone spitting contest*
23. *A place: traces of 'Spring festivals'*
24. *Internal World*
Annemiek-Stéphane Cornelissen-Douady